

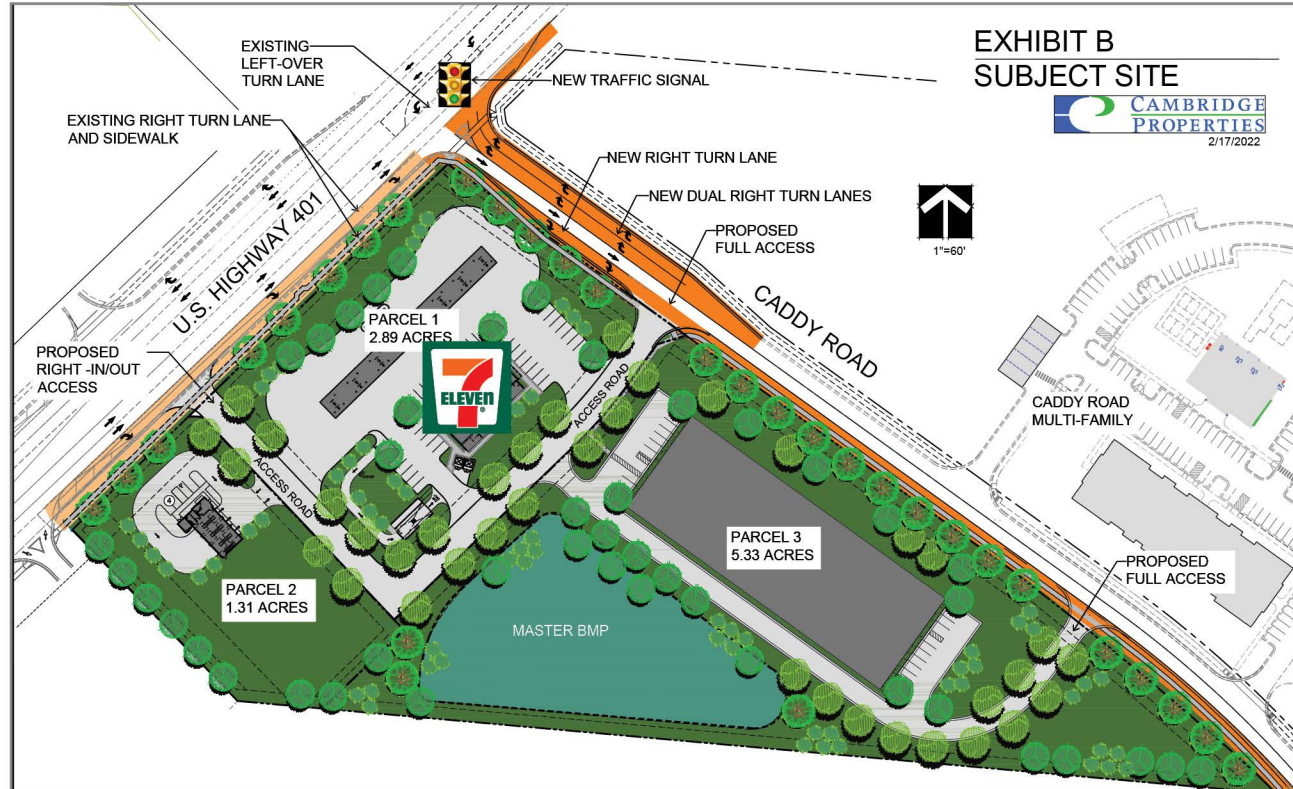

RAND VILLAGE COMMERCIAL / RETAIL

PROPOSED PARCEL PLAN



PARCEL 1	±2.89 AC	7-ELEVEN
PARCEL 2	±1.31 AC	AVAILABLE
PARCEL 3	±5.33 AC	PENDING

NOTE:

- Proposed plan includes ±3.6 acres of additional site area to meet stormwater management and municipal open space requirements.